

# PARAFUSO MAQ-FIX

## CHATA PHILIPS

Material: Aço baixo carbono  
 Acabamento: Zincado branco  
 Rosca: BSW DIN 11 / UNC ASME B1.1  
 NCM: 7318.15.00  
 IPI: Conforme legislação  
 Unidade de venda: cento

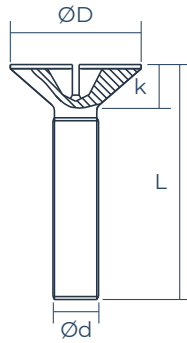

Diâmetro	1/8"	5/32"	3/16"	1/4"
ØD máx	5,5	7	9	11
K ref	1,5	1,9	2,3	2,8
Chave	N1	N2	N2	N3
FPP/Rosca	40/BSW	32/UNC	24/UNC	20/UNC

### L (")

1/4"	<b>3623701</b> 5CTO 10CX R\$4,58	P2 0,051	<b>3625101</b> 5CTO 10CX R\$7,41	P2 0,078				
5/16"	<b>3623801</b> 5CTO 10CX R\$5,59	P2 0,058	<b>3625201</b> 5CTO 10CX R\$8,26	P2 0,094	<b>3626501</b> 5CTO 10CX R\$14,61	P2 0,118		
3/8"	<b>3623901</b> 5CTO 10CX R\$6,04	P2 0,067	<b>3625301</b> 5CTO 20CX R\$8,89	P2 0,103	<b>3626601</b> 5CTO 10CX R\$15,99	P2 0,161	<b>3628201</b> 5CTO 10CX R\$23,98	P4 0,270
1/2"	<b>3624001</b> 5CTO 10CX R\$7,82	P2 0,083	<b>3625401</b> 5CTO 10CX R\$11,22	P2 0,123	<b>3626701</b> 5CTO 10CX R\$19,69	P3 0,183	<b>3628301</b> 5CTO 10CX R\$28,73	P4 0,310
5/8"	<b>3624101</b> 5CTO 10CX R\$9,16	P2 0,095	<b>3625501</b> 5CTO 10CX R\$14,61	P2 0,149	<b>3626801</b> 5CTO 10CX R\$22,02	P4 0,218	<b>3628401</b> 2CTO 10CX R\$35,21	P2 0,364
3/4"	<b>3624201</b> 5CTO 10CX R\$10,95	P2 0,108	<b>3625601</b> 5CTO 20CX R\$16,94	P3 0,169	<b>3626901</b> 5CTO 10CX R\$25,29	P4 0,250	<b>3628501</b> 2CTO 10CX R\$41,48	P3 0,425
7/8"	<b>3624301</b> 5CTO 20CX R\$11,92	P2 0,120	<b>3625701</b> 5CTO 10CX R\$18,42	P3 0,186	<b>3627001</b> 5CTO 10CX R\$25,65	P5 0,278	<b>3628601</b> 2CTO 10CX R\$45,13	P3 0,490
1"	<b>3624401</b> 5CTO 10CX R\$13,41	P2 0,137	<b>3625801</b> 5CTO 10CX R\$20,55	P4 0,214	<b>3627101</b> 5CTO 10CX R\$31,38	P5 0,319	<b>3628701</b> 2CTO 10CX R\$50,76	P4 0,546
1.1/4"	<b>3624501</b> 2CTO 10CX R\$16,39	P2 0,175	<b>3625901</b> 2CTO 10CX R\$25,31	P2 0,261	<b>3627201</b> 2CTO 10CX R\$36,24	P3 0,381	<b>3628801</b> 2CTO 10CX R\$60,59	P4 0,651
1.1/2"	<b>3624601</b> 2CTO 10CX R\$18,13	P2 0,198	<b>3626001</b> 2CTO 10CX R\$26,89	P3 0,305	<b>3627301</b> 2CTO 10CX R\$40,91	P4 0,446	<b>3628901</b> 2CTO 10CX R\$67,50	P5 0,779
1.3/4"	<b>3624701</b> 2CTO 10CX R\$21,37	P3 0,232	<b>3626101</b> 2CTO 10CX R\$31,09	P3 0,355	<b>3627401</b> 2CTO 10CX R\$47,96	P4 0,512	<b>3629001</b> 2CTO 10CX R\$77,74	P5 0,888
2"	<b>3624801</b> 2CTO 10CX R\$24,31	P4 0,259	<b>3626201</b> 2CTO 10CX R\$37,00	P4 0,399	<b>3627501</b> 2CTO 10CX R\$53,21	P5 0,571	<b>3629101</b> 2CTO 8CX R\$87,97	N1 1,013
2.1/4"			<b>3626301</b> 2CTO 10CX R\$41,10	P5 0,462	<b>3627601</b> 2CTO 8CX R\$59,12	N1 0,656	<b>3629201</b> 2CTO 8CX R\$97,75	N1 1,117
2.1/2"	<b>3624901</b> 2CTO 10CX R\$30,39	P5 0,300	<b>3626401</b> 2CTO 10CX R\$50,87	P5 0,508	<b>3627701</b> 2CTO 10CX R\$64,38	P5 0,704	<b>3629301</b> 1CTO 10CX R\$105,85	P5 1,246
2.3/4"					<b>3627801</b> 2CTO 8CX R\$74,45	N1 0,792	<b>3629401</b> 2CTO 8CX R\$115,96	N1 1,409
3"					<b>3627901</b> 2CTO 8CX R\$84,51	N1 0,828	<b>3629501</b> 1CTO 8CX R\$126,08	N1 1,487
3.1/2"					<b>3628001</b> 1CTO 10CX R\$86,28	P5 0,993	<b>3629601</b> 1CTO 8CX R\$129,44	N1 1,721
4"					<b>3628101</b> 1CTO 8CX R\$97,84	N1 1,135	<b>3629701</b> 1CTO 8CX R\$166,99	N1 1,960



P2 L90 C80 A50

P3 L90 C80 A60

P4 L90 C80 A80

P5 L135 C80 A90

N1 L140 C120 A90

Imagens meramente ilustrativas